

## Tapping unit with automatic feed

8340

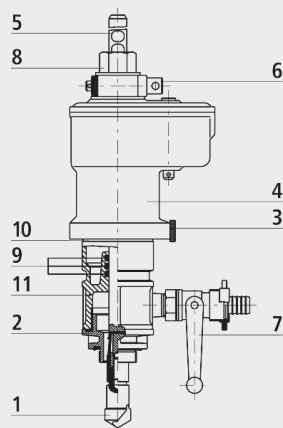

### Components

- 1: Drill
- 2: Thread /ZAK® adapter
- 3: Flat knurled nut
- 4: Automatic feed
- 5: Drill spindle
- 6: Locking bolts
- 7: Flush valve
- 8: Drive nut
- 9: O-Ring
- 10: Red marking
- 11: Guide

### Application

- The tapping unit with automatic feed is specially designed for the efficient tapping of steel and cast pipes. Even pipes with a cement coating can be effortlessly tapped with this unit.

### Caution

- Included in the scope of delivery is the automatic tapping unit with automatic feed and the installation wrench, as well as the transport case. Accessories such as the drill spindle, milling cutter or adapter must be ordered separately.

	weight (kg)
8340V00010	12.000